

Enhanced Aluminum Mirror

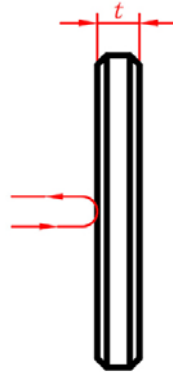

Specifications:

Material.....see the table

Length or width tolerance..... $\pm 0.1\text{mm}$

Diameter tolerance..... $+0/-0.2\text{mm}$

Thickness tolerance..... $\pm 0.20\text{mm}$

Clear Aperture..... $>90\%$

Parallelism..... <3 arc minutes

Surface Quality.....60-40 scratch and dig

Coating.....Enhanced aluminum, $R_{\text{avg}} \geq 93\%$ (450~750nm)

P/N	Size	Flatness	Substrate
50321	$\Phi 12.7 \times 5$	$\lambda/4$	BK7
50322	$\Phi 25.4 \times 5$	$\lambda/4$	BK7
50334	$\Phi 12.7 \times 5$	$\lambda/10$	Fused Silica
50335	$\Phi 25.4 \times 5$	$\lambda/10$	Fused Silica
50345	$\Phi 12.7 \times 6$	$\lambda/20$	Fused Silica
50346	$\Phi 25.4 \times 6$	$\lambda/20$	Fused Silica

- Dimension unit: mm
- Other sizes and coatings are available upon request.