

Dielectric Front Surface Mirror

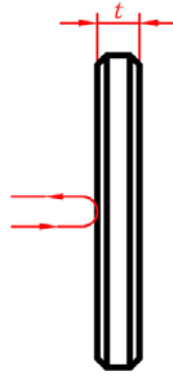

Specifications:

Material.....BK7 grade A optical glass

Dimension Tolerance..... $\pm 0.2\text{mm}$

Clear Aperture..... $> 85\%$

Surface Quality.....60-40

Flatness..... $\lambda/8$ per 25mm @632.8nm

Parallism..... $< 3'(S1//S2)$

Bevel.....0.25mm x 45°

Coating..... $R > 98\%$ on S1, $R = (R_s + R_p)/2$

P/N	Φ	t	AOI	λ
50101	25.40	6.00	0°	632.8nm
50102	25.40	6.00	45°	632.8nm
50103	25.40	6.00	0°	1064nm
50104	25.40	6.00	45°	1064nm

- Dimension unit: mm
- Other sizes and coatings are available upon request.